

INTRODUCING

# ENDOSKELETON® TAS

Anterior Fusion Device for the Lumbar Spine with Integrated Fixation

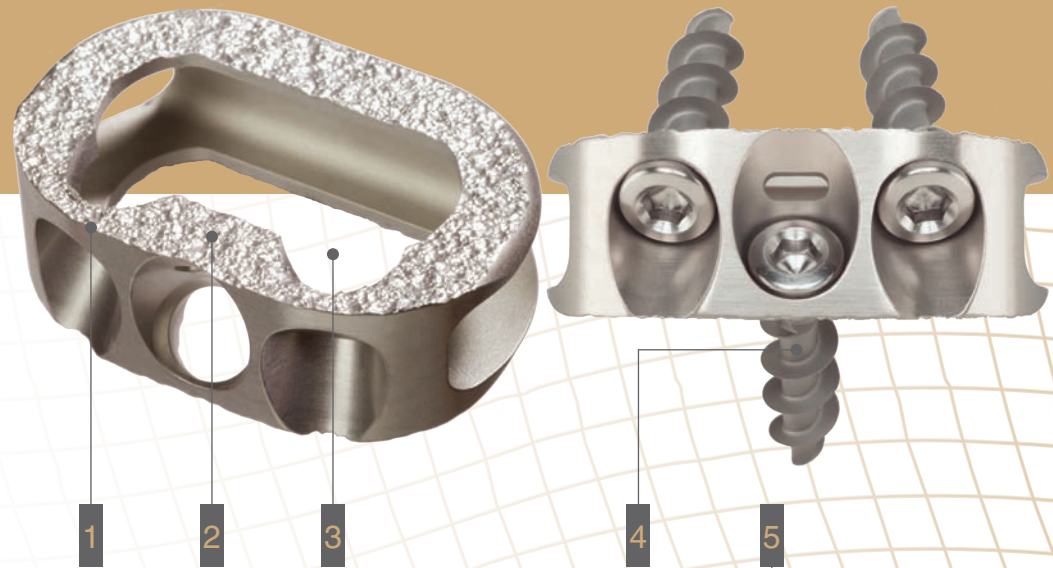

## Results-Oriented Cage

### Unique Features and Benefits

- 1] Apophyseal Fixation and Endplate Sparing**  
 The Endoskeleton® TAS sits on the strongest portion of the endplate yielding excellent resistance to subsidence. Maintains hoop stress of the inferior and superior endplates allowing the transfer of stress through the apophysis.
- 2] Fixation to Bone by Acid-Etched Titanium Surface**  
 Dual Acid-Etched Titanium surface provides a strong press fit and boney ingrowth. Binding to bone with mechanical friction and a bio-chemical bond.
- 3] Large Open Area for Bone Graft**  
 Large open area allows for significant autograft bone packing. Large open windows for outstanding radiographic visualization.
- 4] Mechanical Stability**  
 Three integrated grit-blasted screws provide for immediate mechanical stability with up to 10 degrees of M/L or A/P angular variation.
- 5] Easy, Straightforward Surgical Technique**  
 Available in 16 different sizes. Its smooth leading posterior edge allows for easy insertion.

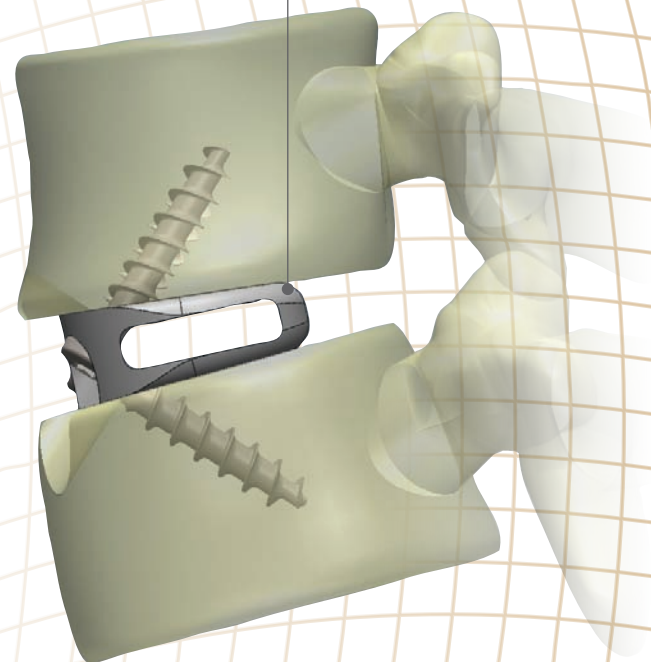

## 16 Different Sizes Give Physicians More Options and a Better Fit



**2307-0210** / 10mm Large

**2307-0211** / 11mm Large

**2307-0212** / 12mm Large

**2307-0213** / 13mm Large

**2307-0214** / 14mm Large

**2307-0215** / 15mm Large

**2307-0216** / 16mm Large

**2307-0217** / 17mm Large

**2307-0310** / 10mm X-Large

**2307-0311** / 11mm X-Large

**2307-0312** / 12mm X-Large

**2307-0313** / 13mm X-Large

**2307-0314** / 14mm X-Large

**2307-0315** / 15mm X-Large

**2307-0316** / 16mm X-Large

**2307-0317** / 17mm X-Large

### Endoskeleton® TAS Device Sizes (mm)

**Large:** 36 width × 24 depth × 10, 11, 12, 13, 14, 15, 16, 17 height = 8 sizes

**X-Large:** 40 width × 27 depth × 10, 11, 12, 13, 14, 15, 16, 17 height = 8 sizes

### Bone Screw Sizes



**5.5mm Diameter**

**2300-5525** / 25mm Length

**2300-5530** / 30mm Length

**6.5mm Diameter**

**2300-6525** / 25mm Length

**2300-6530** / 30mm Length

Please refer to package insert for current warnings, precautions, and instructions for use.  
 © 2011, Titan Spine. All rights reserved. ENDOSKELETON® is a proprietary trademark of Titan Spine.  
 Printed in USA. Literature Part Number 60-0016, Rev 01.



Titan Spine  
 Mequon Research Center  
 6140A W. Executive Drive  
 Mequon, WI 53092  
 (866) 822 7800

[www.titanspine.com](http://www.titanspine.com)